



# Headlamp, Rotary and Fuel Tank Switches

**Push-Pull Headlamp  
Switches**



**Rotary Headlamp &  
Light Switches**

**Universal Rotary  
Switches**

**Rotary Fuel Tank  
Switches**



**Push-Pull Headlamp Switches with Rheostat Dimmer for Panel Lamps**

3 Positions • OFF - PARK & TAIL - HEAD & TAIL

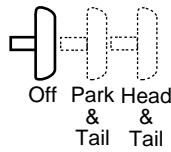

4.5 ohms rheostat dimmer, 15 amp internal circuit breaker.

**No. 71092-02**

**Mounting stem:** 7/16"-28 thread.

**Knob:** black, headlamp symbol imprint.

**Terminals:** 8 blade, accept Packard connector #2977645 or #2984169.

**Case:** plated steel.

Dome lamp control in any of three positions.

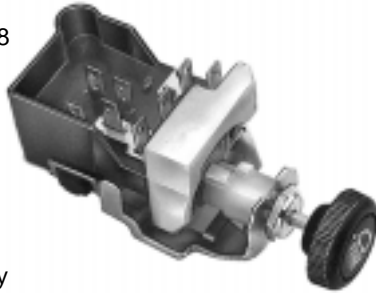

7.0 ohms rheostat dimmer.

**No. 71042**

**Mounting stem:** 3/8"-24 thread.

**Knob:** ivory, LIGHTS imprint.

**Terminals:** 3 single and 3 double blade.

**Case:** plated steel.



3.75 ohms rheostat dimmer, 30 amp circuit breaker.

**No. 7178**

**Mounting stem:** 3/8"-24 thread.

**Knob:** black, LIGHTS imprint.

**Terminals:** 4 screw.

**Case:** plated steel.

Panel lights can be adjusted in both ON positions.



11 ohms rheostat dimmer, 20 amp circuit breaker.

**No. 71016**

**Mounting stem:** 3/8"-24 thread.

**Knob:** tan, LIGHTS imprint.

**Terminals:** 4 screw.

**Case:** plated steel.



**No. 71016-01**

Same as No. 71016 except with 30 amp circuit breaker.

**Push-Pull Headlamp Switches**

3 Positions • OFF - PARK & TAIL - HEAD & TAIL

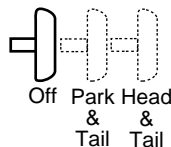

**No. 7124**

**Mounting stem:** 7/16" - 28 thread.

**Knob:** black, LIGHTS imprint.

**Terminals:** 4 screw.

**Case:** plated steel.



30 amp circuit breaker

**No. 7157**

**Mounting stem:** 7/16" - 28 thread.

**Knob:** ivory, LIGHTS imprint.

**Terminals:** three screw.

**Case:** plated steel.

**Contacts:** silver.



**No. 7124-06**

Same as No. 7124 except knob is imprinted with headlamp symbol.



**No. 7152**

**Mounting stem:** 7/16" - 28 thread.

**Knob:** ivory, LIGHTS imprint.

**Terminals:** four screw.

**Case:** plated steel.

**Contacts:** silver.



## Push-Pull Headlamp Switches

3 Positions • OFF - PARK & TAIL - HEAD & TAIL

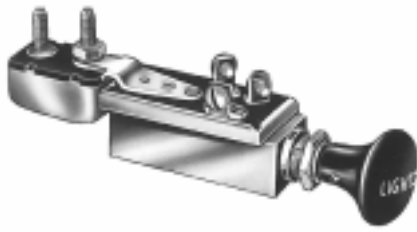

**No. 72101** 30 amp circuit breaker.  
**Mounting stem:** 7/16" - 28 thread.  
**Knob:** black, LIGHTS imprint.  
**Terminals:** 3 screw.  
**Case:** plated die cast.  
**Sealing:** case sealed at bushing and terminal insulator.  
**Contacts:** silver.

**No. 72102**  
 Same as No. 72101 except without sealing.

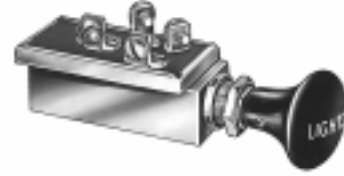
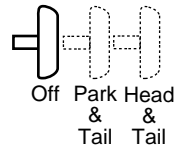

**No. 72100**  
**Mounting stem:** 7/16" - 28 thread.  
**Knob:** black, LIGHTS imprint.  
**Terminals:** 4 screw.  
**Case:** plated die cast.  
**Sealing:** case sealed at bushing and terminal insulator.  
**Contacts:** silver.

⊖ **No. 72099**  
 Same as No. 72100 except without sealing.

**No. 7127** 20 amp fuse.  
**Mounting stem:** 7/16" - 28 thread.  
**Knob:** Ivory, LIGHTS imprint.  
**Terminals:** 4 screw.  
**Case:** plated steel.

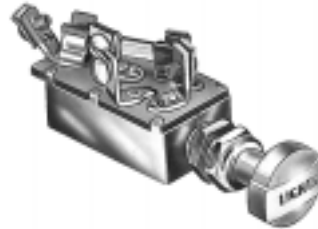

## 4 Position Push-Pull Headlamp and Worklight Switches

**No. 7112** Headlamp Switch  
**Mounting stem:** 3/8" - 24 thread.  
**Knob:** tan, LIGHTS imprint.  
**Terminals:** 5 screw.  
**Case:** plated steel.

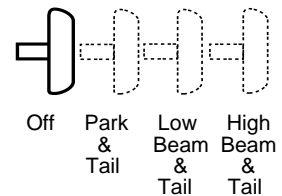

⊖ **No. 72081** Headlamp and worklight switch.  
**Mounting stem:** 7/16" - 28 thread.  
**Knob:** black, headlight symbol imprint.  
**Terminals:** 3 screw.  
**Case:** plated steel.  
**Sealing:** O-ring sealed at mounting stem.

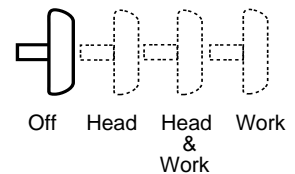

⊖ **No. 71033-02** Worklight switch.  
**Mounting stem:** 7/16" - 28 thread.  
**Knob:** black, worklight symbol imprint.  
**Terminals:** 3 blade.  
**Case:** plated steel.  
**Sealing:** O-ring sealed at mounting stem.

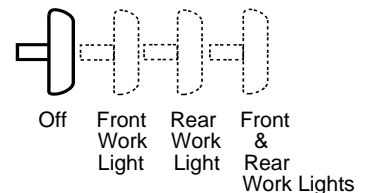

## Rotary Headlamp and Light Switches

### No. 72079-01

**Mounting stem:** 5/8"-32 thread.

**Actuator:** black knob, headlight symbol imprint.

**Terminals:** five screw.

**Case:** plated steel.

**Sealing:** O-ring in mounting stem.

**Contacts:** silver.

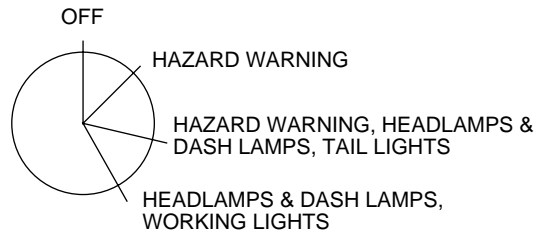

### No. 72023-01

**Mounting stem:** 5/8"-32 thread.

**Actuator:** short lever.

**Terminals:** four screw.

**Case:** plated steel.

**Sealing:** O-ring in mounting stem.

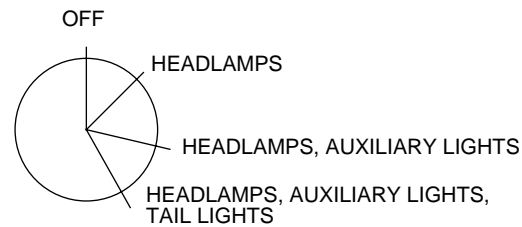

### No. 72051-03

**Mounting stem:** 5/8"-32 thread.

**Actuator:** lever.

**Terminals:** five blade, accept Packard connector #2962912.

**Case:** plated steel.

**Sealing:** O-ring in mounting stem.

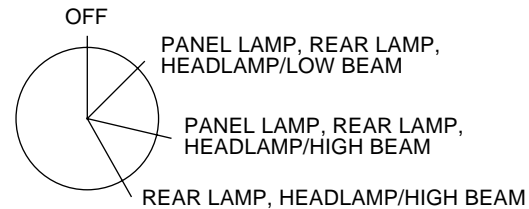

### ⊖ No. 72058-01

**Mounting stem:** 1/2"-20 thread.

**Actuator:** lever.

**Terminals:** four screw.

**Case:** plated steel.

**Sealing:** O-ring in mounting stem.

**Contacts:** silver.

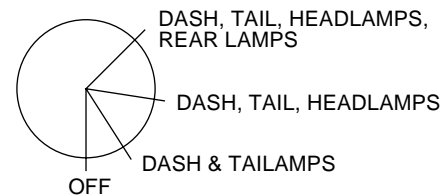

### ⊖ No. 24052

**Mounting stem:** 5/8"-32 thread.

**Actuator:** illuminated tan knob, Fog Lights imprint.

**Terminals:** three screw.

**Case:** plated steel.

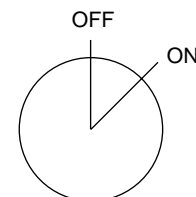

Universal Rotary Switches

Available in a full range of circuitries and styles for lighting, ignition and similar applications.

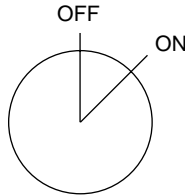

**No. 9500** 10 amps at 12 VDC  
**Mounting stem:** 1/2" - 20 thread.  
**Actuator:** lever.  
**Terminals:** two screw.  
**Case:** plated steel case.

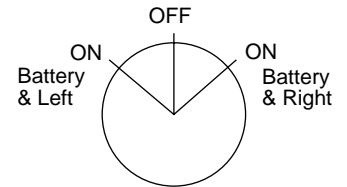

**No. 24054** 10 amps at 12 VDC  
**Mounting stem:** 1/2" - 20 thread.  
**Actuator:** lever.  
**Terminals:** three screw.  
**Case:** plated steel.

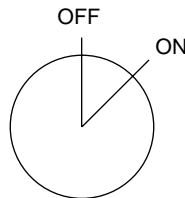

**No. 24053** 10 amps at 12 VDC  
**Mounting stem:** 1/2" - 20 thread.  
**Actuator:** lever.  
**Terminals:** two screw.  
**Case:** plated steel case.

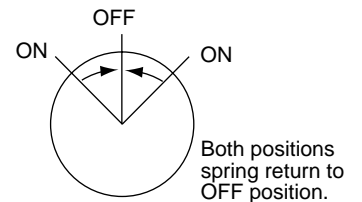

**No. 75701** 20 amps at 12 VDC  
**Mounting stem:** 7/16" - 28 thread.  
**Actuator:** lever.  
**Terminals:** three screw.  
**Case:** plated steel.  
**Contacts:** silver.

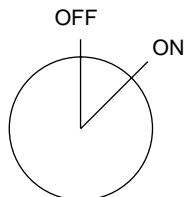

**No. 24051** 5 amps at 12 VDC  
**Mounting stem:** 5/8" - 32 thread.  
**Actuator:** illuminated tan knob, "Switch" imprint.  
**Terminals:** two screw.  
**Case:** plated steel.

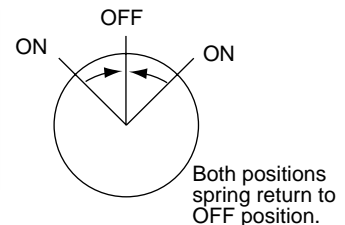

**No. 75705-01** 10 amps at 12 VDC  
**Mounting stem:** 13/16" - 24 thread.  
**Actuator:** key with coded tumbler lock.  
**Terminals:** three screw.  
**Case:** plated steel.

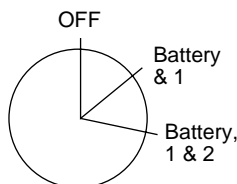

**No. 9802** 20 amp total at 12 VDC  
**Mounting stem:** 5/8" - 32 thread.  
**Actuator:** lever.  
**Terminals:** three screw.  
**Case:** plated steel.  
**Contacts:** silver.

### Universal Reversing Rotary Switches

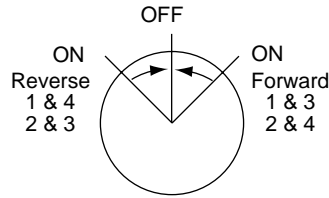

Both positions  
spring return to  
OFF position

**No. 90005-01** 15 amps at 12 VDC

**Mounting stem:** 1/2" - 20 thread.

**Actuator:** lever.

**Terminals:** four screw.

**Case:** plated steel.

**Contacts:** silver.

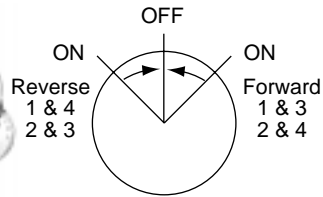

Both positions  
spring return to  
OFF position

**No. 90005-03** 15 amps at 12 VDC

**Mounting stem:** 13/16" - 24 thread.

**Actuator:** coded tumbler lock.

**Terminals:** four screw.

**Case:** plated steel.

**Sealing:** O-ring sealed at stem.

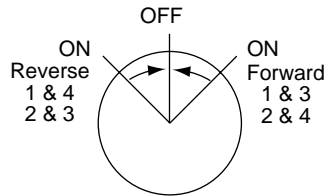

Both positions  
spring return to  
OFF position

**No. 90005-04** 15 amps at 12 VDC

**Mounting stem:** 1/2" - 20 thread.

**Actuator:** lever.

**Terminals:** four screw.

**Case:** plated steel.

**Contacts:** silver.

### Rotary Fuel Tank Switches

For 2 and 4 tank vehicles.

Clearly marked face plates.

Molded black plastic knobs with set screw.

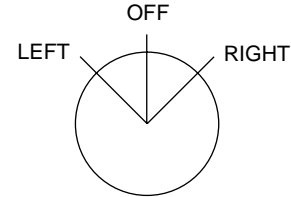

**No. 7511** 2 Tanks

**Mounting stem:** 7/16" - 28 thread.

**Terminals:** 3 screw.

**Case:** plated steel.

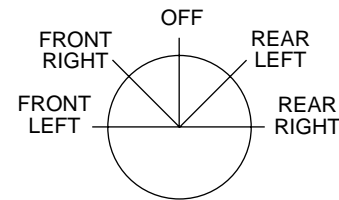

**No. 7510** 4 Tanks

**Mounting stem:** 7/16" - 28 thread.

**Terminals:** 5 screw.

**Case:** plated steel.

**Contacts:** silver.