



Headlamp Dimmer Switches

Through Floorboard Mounted

On Floorboard Mounted

Steering Column Mounted

Panel Mounted



Headlamp Dimmer Switches • SPDT • On-On

Mount through floorboard • Depress-release for LOW beam, depress-release for HIGH beam

Corrosion resistant die cast metal housings • Moisture repellent insulators.

No. 7700

Mounting: three 1/4"-20 tapped holes, 3/4" and 1 3/4" on centers.

Stem: 27/32" diameter.

Terminations: three 16 gauge leads, 5.75" long.

Sealing: heavy plastic coating on case and wire leads.



No. 7787

Mounting: two 1/4"-20 tapped holes, 1 3/4" on centers.

Stem: 7/8" diameter.

Terminals: three screw.

Replaces: **A.M.** 803870, 811681

Chrysler 1689512 **Delco** A-800

Ford A8AZ-13A024A, 7RA, 8A-13532

Motorcraft SW-256, 260



No. 7769

Mounting: three 1/4"-20 tapped holes, 3/4" and 1 3/4" on centers.

Stem: 27/32" diameter.

Terminals: three screw.

Replaces: **Delco** 465A-Z, 471P-Z, 1997002, 1997008, 1997009, 199870014, D-805, U-802
Ford 81A, 11A13532,
Mack 1MR-234



No. 7784

Weather resistant seal in case.

Mounting: three 1/4"-20 tapped holes, 3/4" and 1 3/4" on centers.

Stem: 7/8" diameter.

Terminals: three screw.



⊖ No. 7775

Mounting: two 1/4"-20 tapped holes, 1 3/4" on centers.

Stem: 55/64" diameter.

Terminals: three blade.

Replaces: **A.M.** 3153766
Ford B7AZ-13A024A, FEG-13532A
Motorcraft SW-261



⊖ No. 7770

Mounting: three 1/4"-20 tapped holes, 3/4" and 1 3/4" on centers.

Stem: 27/32" diameter.

Terminations: three combination screw and female bullet terminals, adaptable to many wiring requirements.

Replaces: **Autocar** 8C-01046
Chrysler 855974, 1253003, 1253460, 1450772, 1641552 **Motorcraft** SW-225



No. 7786

Mounting: three 1/4"-20 tapped holes 3/4" and 1 3/4" on centers.

Stem: 1 1/16" diameter.

Terminals: three screw.

Replaces: **Delco** 1997014, D-805

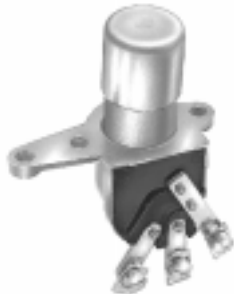

No. 7774

Mounting: two 1/4"-20 tapped holes, 1 3/4" on centers.

Stem: 55/64" diameter.

Terminals: three blade.

Replaces: **Delco** 1997023, D-801
I.H.C. 505452C1 **Motorcraft** SW-258



No. 7771

Mounting: two 1/4"-20 tapped holes, 1 3/4" on centers.

Stem: 55/64" diameter.

Terminals: three blade.

Replaces: **Delco** 1997021, D-800
Motorcraft SW-257



No. 7789-02

Mounting: two 1/4"-20 tapped holes, 1 3/4" on centers.

Stem: 27/32" diameter.

Terminals: three blade.

Drain hole in case.



Headlamp Dimmer Switches • SPDT • On-On

Mount on floorboard • Depress-release for LOW beam, depress-release for HIGH beam

Corrosion resistant die cast metal housings • Moisture repellent insulators.



No. 7702

Mounting: two 7/32" diameter holes, 1 5/8" on centers.

Terminals: three blade.

Replaces: **Delco** U803 **Ford** C0TF, C0TZ-13A024A **Motorcraft** SW-263



No. 7776

Mounting: two 7/32" diameter holes, 1 5/8" on centers.

Terminals: three blade.

Replaces: **A.M.** 3156124, 3160926
Chrysler 1841895, 1881938, 2097628, 2291202, 3488882, CH-247
Delco U-801 **Ford** B9A-13532A



No. 7762

Mounting: two 9/32" diameter holes, 1 3/4" on centers.

Terminals: three blade.

Replaces: **A.M.** 5457282 **Delco** 1997028, 1997031, 1997035, 1997037, 1997040, 1997043, D-803, D-804, D-808, D-809, D-810 **G.M.** 538446, 578005, 1539288

Dimmer Switch Connectors

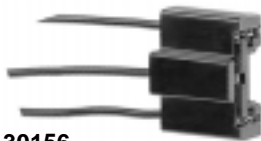

No. 30156

Fits Cole Hersee switches No. 7702 and No. 7776.

Trucks:

Ford 60-87 **Dodge** 59-86



No. 30155

Fits Cole Hersee switch No. 7762.

Trucks:

| | |
|----------------------------|---|
| Autocar 68-80 | I.H.C. 61-80 |
| Chevrolet .. 61-86 | Freightliner .. 63-67, 72-80 |
| G.M.C. 60-86 | Kenworth 65-67, 72-74, 77-80 |

Combination Dimmer and Headlamp Switch • Panel Mounted

Designed for vehicles that are equipped for the handicapped and delivery vans requiring stand-up operation.

No. 7112

Mounting stem: 3/8" diameter, 5/16" long, two flats on stem for mounting in double D shaped hole.

Terminals: five screw.

Case: plated steel.

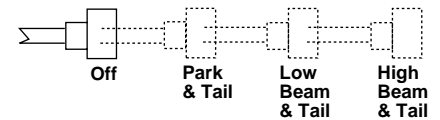
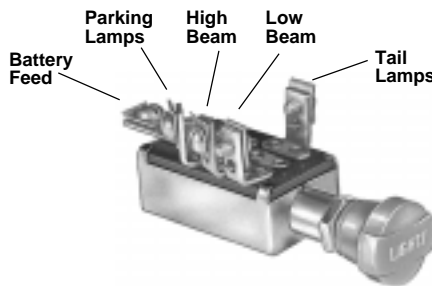

Headlamp Dimmer Switch • SPDT • On-On • Steering Column Mounted

No. 7794

Terminals: three blade.
Replaces: **Delco** 1997045, 7838234, D-812

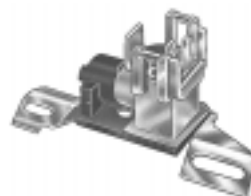

Turn Signal Switches • Normally Off

Mount through floorboard • Depress to On, spring return to Off

Two switches required for left and right turn signals.

No. 7785

Mounting: three 1/4"-20 tapped holes, 3/4" and 1 3/4" on centers.

Stem: 7/8" diameter.

Sealing: weatherproof and dustproof, heavy plastic coating protects against moisture, dust and road splash.



No. 7792

Same as No. 7785 except with exposed screw terminals and no wire leads.

No. 7792-01

Same as No. 7792 except without plastic coating.



Foot Operated Starter Switches

Off-On, normally Off • On with plunger depressed, spring return to Off • Copper contacts and terminal studs

No. 9060

Mounting: two 7/32" (7.14mm) diameter holes, 1 3/4" (44.45mm) on center.

Terminals: two stud, 5/16"-24 thread with hex nuts and lockwashers.

Plunger: 1.83" (46.48mm) plunger extension.

Replaces: **Autolite** SW-40001 (15-47), 15-50, 4001A, 4002, 4005, 4010, 4015, (15-51)

Delco D900 (405C)



No. 91001

Mounting: two 7/32" x 9/32" (5.55mm x 7.14mm) holes, 1.40" (35.56mm) on centers.

Terminal: one stud, 3/8"-16 thread with 8-32 for attaching external ground wire.

Plunger: 2 1/32" (16.66mm) plunger extension.

Replaces: **Autolite** 15-201 **Delco** 1930496 (D906)



No. 9183

Same as No. 9060 except with 1" (25.40mm) plunger extension.

Replaces: **Autolite** SW-4012 (15-49)

Delco 1996478

