



Neutral Safety, Back-Up Lamp & Alarm, Overdrive Kickdown Switches

Mechanical

Vacuum



Heavy Duty Neutral Safety Switches • For applications to 36 VDC

SPST • Normally Off • On with plunger depressed, spring return to Off.

Silver contacts • Moisture resistant insulators • Corrosion resistant metal housings.

No. 9242

Terminals: two screw.

Mounting stem: 1/16"-18 UNF-2A thread, 5/16" long.

Replaces: **I.H.C.** 863187-R91



No. 9242-01

Same as No. 9242 except with brass gasket/washer.

No. 9242-04

Wire harness: 22" long, includes two pole Packard connector #2984855 with two female blade terminals.

Mounting stem: 1/16"-18 UNF-2A thread, 5/16" long.

Housing: plasticized for moisture and dirt protection.

Replaces: **G.M.** 702733



No. 92102

Terminals: two button head, accept standard female blade terminals; will mate with Packard 2 pole connector #2962679 or equivalent.

Mounting stem: 1/16"-18 UNF-2A thread, 2 1/32" long.



⊖ No. 92102-03

Same as No. 92102 except with aluminum gasket/washer.

No. 92107-04

Terminals: two screw.

Mounting stem: 3/4"-16 UNF-2A thread, 3 1/64" long with aluminum gasket/washer.



No. 9162

Terminals: two female bullet.

Mounting stem: 3/4"-16 UNF-2A thread, 3 1/64" long.

Replaces: **Chrysler** 1527835 **Clark** 733631



No. 9162-03

Same as No. 9162 except with gasket on mounting stem and golden dipped housing.

Replaces: **Massey** 181140M94

⊖ No. 9242-07 Self Grounding

Terminals: two screw, one terminal grounded to switch housing.

Mounting stem: 1/16"-18 UNF-2A thread 5/16" long.

Sealing: terminal insulator sealed against moisture and dirt.

Replaces: **John Deere** AT71501



SPST • Normally On • Off with plunger depressed, spring return to On.

Silver contacts • Moisture resistant insulators • Corrosion resistant metal housings.

No. 9224

Terminals: two screw.

Mounting stem: 3/4"-16 UNF-2A thread, 3 1/64" long with aluminum gasket/washer.

Replaces: **Clark** 224620



No. 9224-07

Same as No. 9224 except with mounting stem 1/16"-18 UNF-2A thread and without gasket/washer.

⊖ No. 92105

Terminals: two female bullet.

Mounting stem: 3/4"-16 UNF-2A thread, 3 1/64" long with aluminum gasket/washer.



Protective Boot

For neutral safety and back-up lamp switches.

No. 83377

Molded of durable PVC to repel moisture, dirt, etc.

Internal ring engages with groove around switch housing.

Fits Cole Hersee switches with 1 1/8" hex housing: Nos. 9134, 9162, 9224, 9242, 9242-07, 92102, 92103, 92105 and 92107-04.



Lever Actuated Neutral Safety Switch

SPST • Normally Off, contacts open • Lever actuated to On, spring return to Off.

No. 8486-05

Terminals: two bullet.

Mounting: two #10-32 tapped mounting holes, 5/8" on centers.

Lever: 2 7/8" long.

Replaces: **John Deere** AM38713.

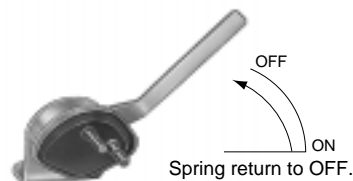

Vacuum Neutral Safety Switches

SPST • Normally Off

Contacts close at rising vacuum, contacts open at lowering vacuum.

No. 92007

Operating pressure: 7 to 13 inches of mercury.

Mounting stem: 1/8"-27 dryseal thread (N.P.T.F.) 1 1/32" long.



SPST • Normally On

Contacts open at rising vacuum, contacts close at lowering vacuum.

No. 9253

Operating pressure: 9 to 12 inches of mercury.

Mounting stem: 1/8"-27 dryseal thread (N.P.T.F.) 1 1/32" long.

Replaces: **A.M.** 3156149 **Chrysler** 1770093, CH-2569 **Ford** C2TA-11516-A



No. 8641

Self Grounding

Operating pressure: 9 to 12 inches of mercury.

Mounting stem: 1/8"-27 dryseal thread (N.P.T.F.) 1 1/32" long.

Replaces: **A.M.** 3157963, 3202448, 8127214 **I.H.C.** 1961198-R91



Neutral Safety and Back-Up Lamp Switches • SPST • Normally Off

On with plunger depressed, spring return to Off • For use with automatic transmissions.

No. 92021

Mounting stem: 3/4"-16 UNF-2A thread, 1 5/32" long with seating washer.

Replaces: **A.M.** 3218190, 3232844

Chrysler 2932820, 2926495, 4057750, CH-2573

Delco 1972523 **I.H.C.** 424705C1



No. 92001

Replaces: **Delco** D2200

G.M. 1993556, 613, 618, 619, 658, 659, 669, 1998677

Motorcraft SW-496



Back-Up Lamp Switch • Plasticized housing

No. 91105

Terminations: two 18 gauge wire leads 7" long.

Mounting stem: 7/16" dia., 7/16" long with two flats for mounting in double "D" shaped hole.

Actuator: button head plunger 3/8" long.

Housing: plasticized, protects against moisture and dirt.

Replaces: **A.M.** 3171244.



Replacement Neutral Safety Switch

For GM cars and trucks with manual transmissions. Clutch operated. Circuitry per OEM specifications.

No. 91123

Replaces: **G.M.** 356113, 3990894, 6273381

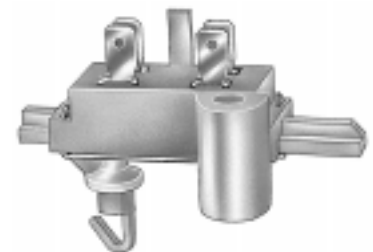

Back-Up Lamp Switches • SPST • Normally Off

On with plunger depressed, spring return to Off.

No. 9134 Transmission mounted • Extra Heavy Duty

Terminals: two female bullet.

Mounting stem: 5/16"-18 thread, 5/16" (7.94mm) long.

Compact design for mounting in areas where space is limited.

 Replaces: **Chrysler** 1343998, 2198779

Motorcraft SW-410.

No. 91113 Transmission mounted • Extra Heavy Duty

Terminals: two screw.

Mounting stem: 5/16"-18 thread, 5/16" (7.94mm) long.

Compact design for mounting in areas where space is limited.

 Replaces: **Autocar** 8E-01360 **Brockway** 128537

Diamond Reo 560-65 **Kenworth** AT-91-69

Mack 1MR-1320 **Oshkosh** 13320-F1 **White** 1743529

No. 91115-03 Transmission mounted

Terminals: Two button head, accept standard female blade terminals; will mate with two pole Packard connector #2962679 or equivalent.

Mounting stem: 5/16"-18 INF-2A thread, 5/16" long.

 Replaces: **Jeep** 948345, 5353441

No. 9025
Terminals: two screw.

Mounting stem: 7/16" dia., 7/16" long with two flats on stem for mounting in double D-shaped hole.

Plunger: 1/2" long.

 Replaces: **Superior School Bus** B67176.

No. 9052

Same as No. 9025 except with button head plunger.

 Replaces: **Ford** B9AF, C0AF,

 51-A15520A **Jeep** 710412, 721028

Motorcraft SW-410.

No. 9176

Same as No. 9052 except with blade terminals.

 Replaces: **A.M.** 3147682.

No. 9054
Terminals: two screw.

Mounting stem: 5/8"-32 thread, 5/8" long.

Sealing: O-ring in stem and gasket under the terminal insulator.

 Replaces: **Ward School Bus** 009 31 014-00.

Overdrive Kickdown Switches • SPST • Normally On

Off with plunger depressed, spring return to On.

No. 9096-02
Terminations: two 16 gauge wire leads 3" long with female bullet terminals; insulator sleeves protect connections.

Mounting holes: 13/64" dia., 1 1/2" on centers.

Sealing: plasticized body seals against moisture and dirt.

Special diaphragm/mounting bracket sealed to protect operating shaft.

Plunger: 1/4" long.

No. 9208
Terminals: two blade and two female bullet.

Mounting stem: 7/16" dia., 5/8" long with two flats on stem for mounting in double D-shaped hole.

Sealing: gasket sealed terminal insulator.

 Replaces: **A.M.** 3146726.

Overdrive Kickdown Switch • SPST • On - Momentary On

Two circuits: No. 1 normally energized; No. 2 energized with plunger depressed, spring return to No. 1.

No. 9106-02
Terminals: four screw.

Mounting stem: 7/16" dia., 7/8" long with flat on stem for mounting in D-shaped hole.

Sealing: gasket sealed terminal insulator.

Plunger: 7/32" long.

 Replaces: **Chrysler** 1479527 **Jeep** 717589

Extra Heavy Duty Weather Resistant Switches
Back-Up Lamp • Neutral Safety • Overdrive • Universal Applications.

SPST • Normally On

Off with plunger depressed, spring return to On.



No. 91042

Terminals: two blade, mate with 2 pole Packard connector #2977647 or equivalent.

Mounting stem: 5/8" dia., 1 1/16" long.

Sealing: gasket sealed terminal insulator.

Rubber cap/seal snaps into grooves in plunger and mounting stem to protect operating shaft from moisture and dirt.

Plunger: 3/8" long, protrudes through cap.

⊖ No. 91042-05

Same as No. 91042 except with two screw terminals.

Replaces: **Fiat Allis** 7307175501



No. 90043

Terminals: two blade, mate with 2 pole Packard connector #2977647 or equivalent.

Mounting stem: 5/8"-32 thread, .625" long.

Sealing: gasket seal in case.

Rubber cap snaps into special groove and is secured to mounting stem by a deep threaded nut for positive seal.

Plunger: steel, protrudes through cap.

SPST • Normally Off

On with plunger depressed, spring return to Off.

No. 92116

Terminals: two blade, mate with 2 pole Packard connector #2977647 or equivalent.

Mounting stem: 5/8" dia., 1 1/16" long.

Sealing: gasket sealed terminal insulator.

Rubber cap/seal snaps into grooves in plunger and mounting stem to protect operating shaft from moisture and dirt.

Plunger: 3/8" long, protrudes through cap.



SPDT • On - Momentary On

Two circuits: No. 1 normally On, No. 2 On with plunger depressed, spring return to No. 1

No. 91127

Terminals: three screw.

Mounting stem: 5/8" dia., 1 1/16" long.

Sealing: gasket sealed terminal insulator.

Rubber cap/seal snaps into grooves in plunger and mounting stem to protect operating shaft from moisture and dirt.

Plunger: 7/16" long, protrudes through cap.



Back-Up Alarm Switches

SPST • Normally Off • Lever actuated to On, spring return to Off.

⊖ No. 75125-06

Terminals: two screw.

Mounting: two 1 3/64" dia. mounting holes, 1/2" on centers.

Sealing: "O" ring in operating shaft.

Lever: 2 1/2" long.

Replaces: **John Deere** AE39927.

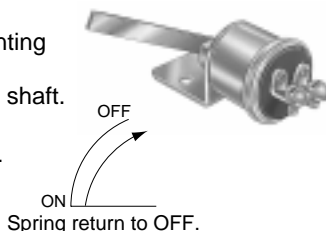

No. 75125

Terminals: two screw.

Mounting: two 1 3/64" (5.15mm) dia. mounting holes, 1/2" (12.70mm) on centers.

Lever: 5" (127mm) long.

